



# 10 CALLE CRISTOVAL



3 Bedroom • 2 Bath • 1,752 SF • \$375,000 • MLS# 202101590



## LIVING & DINING

↻ Hardwood Floors ↻ Remodeled Kitchen





# 10 CALLE CRISTOVAL

3 Bedroom • 2 Bath • 1,752 SF • \$375,000 • MLS# 202101590

Recently renovated manufactured 3-bedroom, 2-bath single-level, Northern New Mexico style home on 1.75 acres, with gorgeous views of the Sangre de Cristo and Sandia Mountains. The light-filled main living area has hardwood floors and decorative shelving, and is adjacent to a large sunroom. A remodeled kitchen has new stainless-steel appliances, ample cabinet space, plus a wine fridge, and the dining area includes a built-in buffet. The split bedroom plan provides privacy and comfort for guests. A large master bedroom has a remodeled en-suite bath and a walk-in closet. The attached bonus room provides space for an office or hobby room. Its walled entry courtyard is perfect for al-fresco dining. Forced air and baseboard heating, evaporative cooling. Easy access to I-25 and the Hwy 599 bypass means that Santa Fe's restaurants, shopping, cultural attractions, and services are only minutes away.

DARLENE STREIT | 505.920.8001 | DSTREIT@DSTREIT.COM



## B E D R O O M S

↪ Split Bedroom Plan ↪ Bonus Room



# DETAILS

- Manufactured Home
- 3 Bedrooms
- 2 Full Baths
- 1752 SF
- 1.75 Acres
- Wood, Tile, Laminte, Carpet Floors
- Frame, Stucco Construction \*
- Pitched, Asphalt Shingle Roof
- Gas Cooking
- Forced Air, Gas Heating
- Evaporative, Central Cooling
- Septic
- Shared Well
- Internet: DSL, Satellite
- Wine Fridge

\*Buyer to Verify

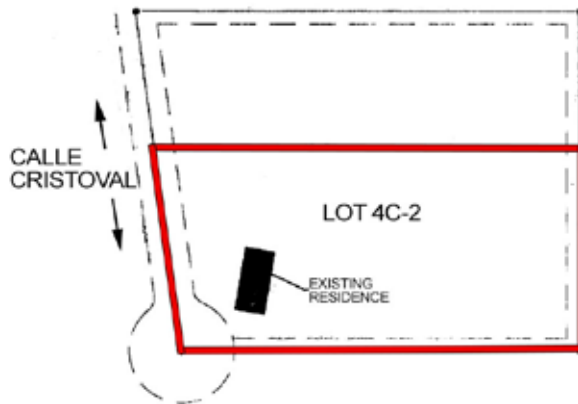

*Plat depiction is for illustration purposes and may not be entirely accurate.*

**DARLENE STREIT**

SANTA FE REAL ESTATE PROPERTY



**DARLENE STREIT**  
505.920.8001 ▪ dstreit@dstreit.com  
Office: 417 E. Palace Avenue  
Santa Fe NM 87501

SantaFeRealEstateProperty.com

DarleneStreit.com

SantaFeLuxuryHomesandLand.com



View  
Listing  
Online

© Sotheby's International Realty, Inc. All rights reserved. Sotheby's International Realty® is a registered trademark. This material is based upon information which we consider reliable but because it has been supplied by third parties, we cannot represent that it is accurate or complete and it should not be relied upon as such. This offering is subject to errors, omissions, changes including price or withdrawal without notice. If your property is listed with a real estate broker, please disregard. It is not our intention to solicit the offerings of other real estate brokers. We are happy to work with them and cooperate fully. Operated by Sotheby's International Realty, Inc. Real estate agents affiliated with Sotheby's International Realty, Inc. are independent contractor sales associates and are not employees of Sotheby's International Realty, Inc. Equal Housing Opportunity. Sotheby's International Realty, 326 Grant Ave, Santa Fe, NM 87501, 505-988-2533.

**Sotheby's**  
INTERNATIONAL REALTY