

100 Pena Place

2 Bedroom / 3 Bath / 1600 SF • \$795,000 • MLS# 202001884

DARLENE STREIT

SANTA FE REAL ESTATE PROPERTY

505.920.8001 • dstreit@dstreit.com

417 E. Palace Avenue • Santa Fe NM 87501

100 Pena Place

2 Bedroom / 3 Bath / 1600 SF

\$795,000 • MLS# 202001884

100 PENA PLACE - PLAT

This depiction is for illustration purposes and may not be entirely accurate

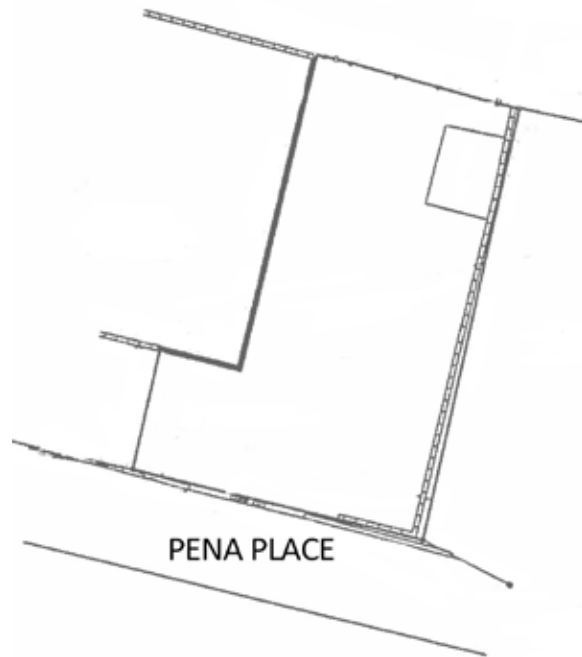

Built in 2017, this 2 bedroom 3 bath home is conveniently located near the Santa Fe Plaza and the Railyard. Clean modern lines and stylish contemporary fixtures and finishes mixed with traditional vigas and beams. Open concept living, dining and kitchen with high ceilings and lots of natural light. Gourmet kitchen has well-appointed appliances, skylight, windows, and a breakfast bar with seating for 2. The dining area has French doors to an outdoor portal which provides extra space for entertaining and dining. Good separation of bedrooms

for privacy. The master suite has a kiva fireplace, ensuite bath and walk-in closet. A finished basement room with bath and outdoor access is perfect for a media room, office or studio. Wood and tile floors throughout. Highlighted features include landscaping, security system, 2 off-street parking spaces, and certification as a Build Green New Mexico ANSI Standard and LEED-H home. Close to shopping, restaurants, theaters, museums and galleries.



DARLENE STREIT

SANTA FE REAL ESTATE PROPERTY

505.920.8001 • dstreit@dstreit.com

417 E. Palace Avenue • Santa Fe NM 87501



LISTINGS

Scan this QR Code with your mobile phone's camera to view Darlene's and all listings online.

Or go to:
SantaFeRealEstateProperty.com

To view additional photos of this property visit: SantaFeRealEstateProperty.com

Sotheby's International Realty and the Sotheby's International Realty logo are registered (or unregistered) service marks used with permission. Operated by Sotheby's International Realty, Inc. Real estate agents affiliated with Sotheby's International Realty, Inc. are independent contractor sales associates and are not employees of Sotheby's International Realty, Inc.

This material is based on information which we consider reliable, but because it has been supplied by third parties, we cannot represent that it is accurate or complete, and it should not be relied upon as such. This offering is subject to errors, omissions, change of price, or withdrawal without notice. EQUAL HOUSING OPPORTUNITY.

Sotheby's

INTERNATIONAL REALTY

326 Grant Ave, Santa Fe, NM 87501

505-988-2533





Clean, Modern Lines - Near the Railyard

- 2 Bedrooms
- Baths: 1 Full, 2 Three Quarter
- 1600 Sq. Ft.
- 0.069 Acres
- Built in 2017
- Frame, Stucco Construction *
- Flat Roof
- 2 Off Street Parking Spaces
- 2 Fireplaces
- Wood, Tile Floors
- Gas Cooking
- Ductless (MiniSplit), Radiant In Floor Heating
- Ductless Cooling
- City Sewer
- City Water
- Internet: Cable, DSL
- Insulated Windows
- Landscaped
- Security System
- Drip/Sprinkler System
- Tankless Hot Water
- EnergyStar Appliances
- LEED-H

**Buyer to Verify*

