

DARLENE STREIT

SANTA FE REAL ESTATE PROPERTY

505.920.8001 • dstreit@dstreit.com

417 E. Palace Avenue • Santa Fe NM 87501

1036 Canyon Rd

2 Bedroom / 2 Bath / 1519 SF

\$945,000 • MLS# 202001850



Sure to inspire and delight the senses, this tastefully remodeled 2 bedroom and 2 bath home on famed Canyon Road boasts classic Southwest charm and unique design touches. Pass through the hand painted front gate, and enter the private garden, landscaped with mature shade trees and wildflowers. The living room offers plenty of natural light, viga and wood ceiling, brick flooring, a Kiva fireplace, and access to the covered portal. The open flow between the living/dining room, and kitchen makes entertaining a breeze. The gourmet kitchen showcases custom wood cabinetry, granite countertops, and recently updated stainless steel appliances including an induction range added in October 2019. Your eyes will be drawn to the details in the master bedroom; handmade doors with

rice paper backing, willow twig window blinds, and private access to the covered portal. The same attention to detail follows through to the master bathroom featuring custom wood vanity with tile countertop, Talavera tile back splash, tiled tub and shower surround, and walk-in closet. The 2nd bedroom with ensuite bathroom ensures that guests will have their own space to relax and unwind. This home also features antique, European chandeliers and sconces, vigas and wood ceilings throughout, brick and Saltillo tile floors, hand-carved wood doors, and glass skylights (2 with rain sensors and remotes). Perfectly located on Canyon road where art galleries and fine dining are just a short distance from your front door!







Classic Southwest Charm on the Historic Eastside

- 2 Bedrooms
- 2 Full Baths
- Main House 1519 Sq. Ft.
- 0.10 Acre
- Construction may be part adobe; buyer to verify
Substructure is rock/rubble foundation.
- Flat Roof
- 2 Off Street Parking Spaces
- 1 Fireplace
- Electric Cooking
- Gas, Radiant Heating
- City Sewer
- City Water
- Internet: Cable, DSL
- Landscaped
- Drip/Sprinkler Irrigation
- Water Purification
- Water Softener
- Security System

**Buyer to Verify*



1036 Canyon Rd

2 Bedroom / 2 Bath / 1519 SF ▪ \$945,000 ▪ MLS# 202001850

1036 CANYON RD - PLAT

This depiction is for illustration purposes and may not be entirely accurate

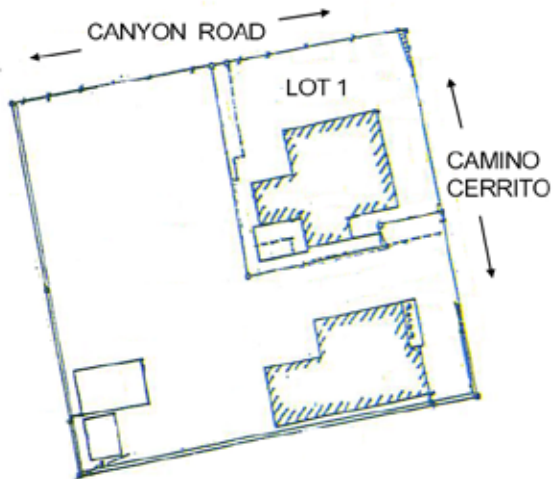

DARLENE STREIT

SANTA FE REAL ESTATE PROPERTY

505.920.8001 ▪ dstreit@dstreit.com

417 E. Palace Avenue ▪ Santa Fe NM 87501



LISTINGS

Scan this QR Code with your mobile phone's camera to view Darlene's and all listings online.

Or go to:
SantaFeRealEstateProperty.com

To view additional photos of this property visit: SantaFeRealEstateProperty.com

Sotheby's International Realty and the Sotheby's International Realty logo are registered (or unregistered) service marks used with permission. Operated by Sotheby's International Realty, Inc. Real estate agents affiliated with Sotheby's International Realty, Inc. are independent contractor sales associates and are not employees of Sotheby's International Realty, Inc.

This material is based on information which we consider reliable, but because it has been supplied by third parties, we cannot represent that it is accurate or complete, and it should not be relied upon as such. This offering is subject to errors, omissions, change of price, or withdrawal without notice. EQUAL HOUSING OPPORTUNITY.

Sotheby's

INTERNATIONAL REALTY

326 Grant Ave, Santa Fe, NM 87501
505-988-2533