

688 La Viveza Ct

3 Bedroom / 3 Bath / 2200 SF • \$735,000 • MLS# 202000836

DARLENE STREIT

SANTA FE REAL ESTATE PROPERTY

505.920.8001 • dstreit@dstreit.com

417 E. Palace Avenue • Santa Fe NM 87501

688 La Viveza Ct

3 Bedroom / 3 Bath / 2200 SF

\$735,000 • MLS# 202000836

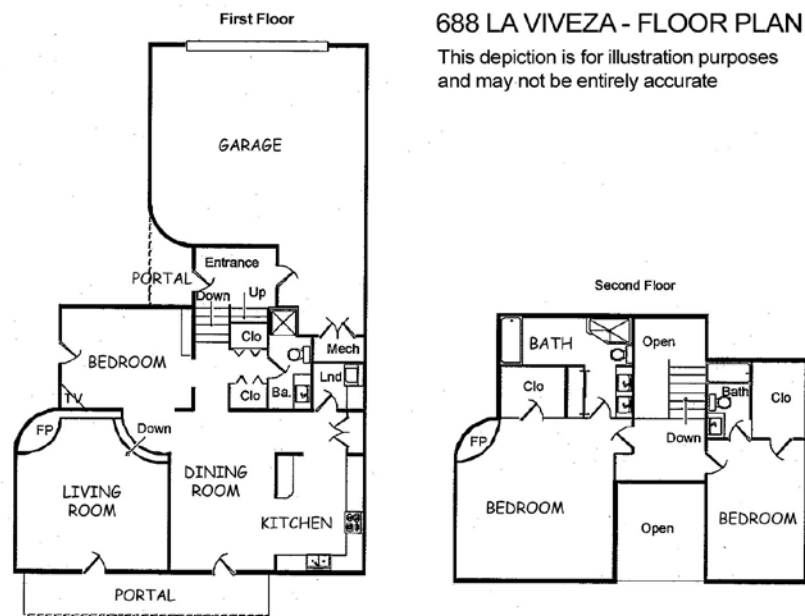

688 LA VIVEZA - PLAT
This depiction is for illustration purposes and may not be entirely accurate

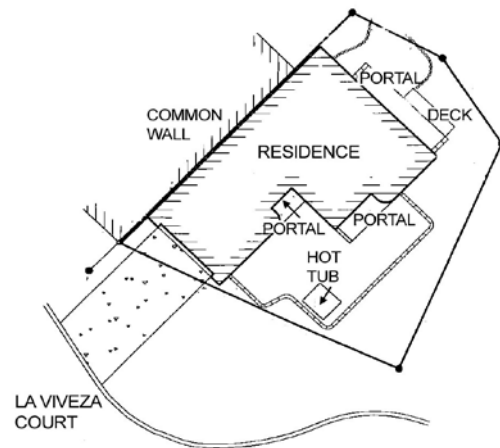

Attention to detail is evident in this extensively remodeled 3 bedroom 3 bath home set on .102 acres in the Estancia Primera community. Inside the courtyard the stone walkway meanders through the landscaped courtyard and surrounding gardens designed by Clemens and Associates. Through the custom Morelli front door, the landing invites you into the flowing floor plan allowing for easy movement between the kitchen, dining and living room. The kitchen has been completely redesigned with high end granite stone backsplashes, pecan and alder cabinets, Rocky Mountain hardware and crystal doorknobs, as well as both bathrooms which were redesigned including Kalista and Barbra Barry by Kohler sinks and fixtures. A guest bedroom on the first floor

has plenty of closet space and a bathroom. The upstairs master bedroom has a fireplace, balcony and ensuite bathroom with dual sink vanity and gorgeous stone-tiled walk-in shower, and extra deep Kohler tub with stone tile accents. An upstairs loft landing overlooks the dining area below. Additional features include custom artisan crafted iron handrails and tinwork, Hunter Douglas Silhouette shades, California closets throughout, WiFi security system, and 2 car garage. Entertain outdoors with 2 fabulous private, landscaped spaces with drip irrigation on timers and accent lighting. An arroyo behind the home adds an extra layer of privacy. Just off of Hyde Park Rd, this home is minutes from the Santa Fe Plaza, Ski Basin and Ten Thousand Waves.



DARLENE STREIT

SANTA FE REAL ESTATE PROPERTY

505.920.8001 • dstreit@dstreit.com

417 E. Palace Avenue • Santa Fe NM 87501



LISTINGS

Scan this QR Code with your mobile phone's camera to view Darlene's and all listings online.

Or go to:
SantaFeRealEstateProperty.com

To view additional photos of this property visit: SantaFeRealEstateProperty.com

Sotheby's International Realty and the Sotheby's International Realty logo are registered (or unregistered) service marks used with permission. Operated by Sotheby's International Realty, Inc. Real estate agents affiliated with Sotheby's International Realty, Inc. are independent contractor sales associates and are not employees of Sotheby's International Realty, Inc.

This material is based on information which we consider reliable, but because it has been supplied by third parties, we cannot represent that it is accurate or complete, and it should not be relied upon as such. This offering is subject to errors, omissions, change of price, or withdrawal without notice. EQUAL HOUSING OPPORTUNITY.

Sotheby's

INTERNATIONAL REALTY

326 Grant Ave, Santa Fe, NM 87501

505-988-2533





Extensively Remodeled Home at Estancia Primera

- 3 Bedrooms
- Baths: 2 Full, 1 Three Quarter
- 2200 Sq. Ft.
- 0.102 Acres
- Built in 1993
- Frame, Stucco Construction *
- Flat, Tar & Gravel Roof
- 2 Garage Spaces
- 2 Fireplaces
- Gas Cooking
- Baseboard, Gas, Radiant In Floor

- Heating
- City Sewer
- City Water
- Internet: Cable
- HOA Fees:
 - Estancia Primera HOA \$656/yr.
 - La Viveza HOA \$225/yr.
- HOA Fees Cover:
 - Estancia Primera: Clubhouse, Common Area
 - La Viveza: Some Street Maintenance

- nance (grading), Electricity for Signage, Mailbox, Street Lamps and House Number, Standard Insurance, Gardening, Snow Plowing
- Insulated Windows
- Landscaped
- Drip/Sprinkler System
- Security System

**Buyer to Verify*

