

# 18 & 20 Mustang Mesa

3 Bedroom / 4 Bath / 4590 SF • \$1,895,000 • MLS# 201903630

# DARLENE STREIT

SANTA FE REAL ESTATE PROPERTY

505.920.8001 • dstreit@dstreit.com

417 E. Palace Avenue • Santa Fe NM 87501

# 18 & 20 Mustang Mesa

3 Bedroom / 4 Bath / 4590 SF

\$1,895,000 • MLS# 201903630

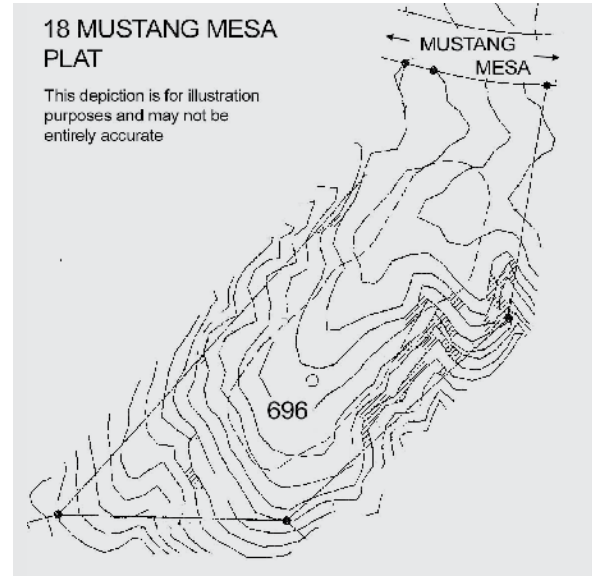
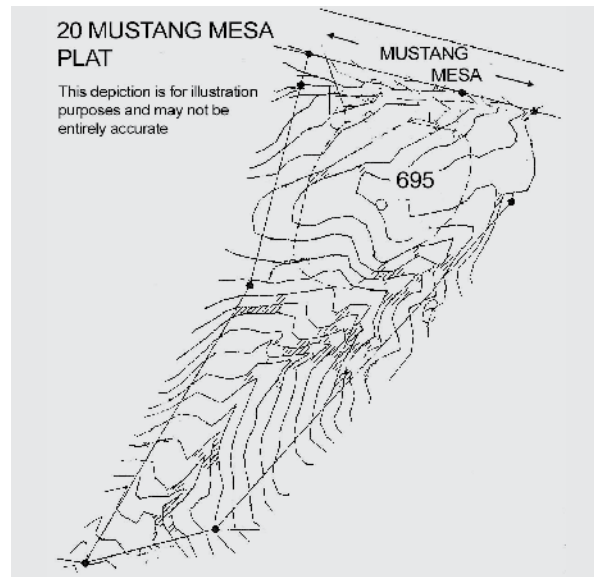

18 MUSTANG MESA - FLOOR PLAN

This depiction is for illustration purposes and may not be entirely accurate

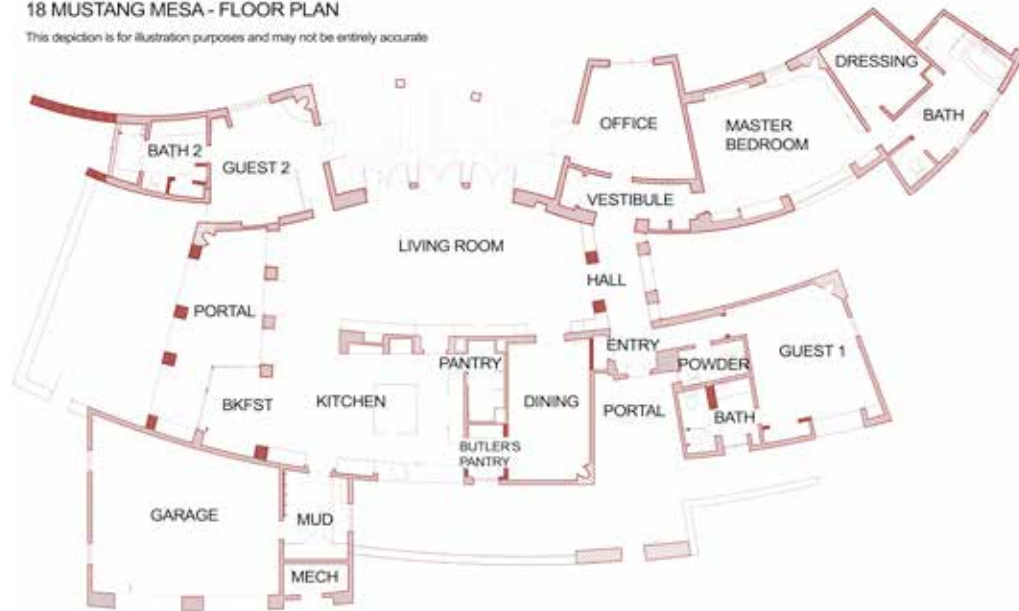

Beautiful contemporary 3 bed 4 bath home built by Tierra Concepts, offered with adjacent lot, is encompassed by 4.5 acres in the desirable Las Campanas gated community. Thoroughly updated to enhance the elegance of each space, it has large windows throughout providing an abundance of natural light and views of the mountains and golf course from nearly every room. The large living room, with high ceilings and clerestory windows, shares a 2-sided fireplace with the kitchen, offering the versatility of a cozy meal by a fire or relaxing in the warm ambiance with guests. The living room opens up to a large portal with outdoor cooking area and fireplace, so entertaining flows seamlessly from inside to outside. The media room offers a stunning 3-TV array for unrivaled

theater quality viewing. The modern kitchen has concrete countertops, center island with a sink and seating for 3, high-end stainless steel appliances including built-in espresso machine, wine closet and access to the formal dining room showcasing a glass enclosed wine wall. Spacious master suite features kiva fireplace, bench seating and walk-in closet with custom wood built-ins. Master bathroom includes a dual sink "floating" vanity with concrete countertop, soaking tub, walk-in shower, tile and stone flooring and wall accents. Offering plenty of room and privacy for guests, the other 2 bedrooms each have a fireplace and private bathroom. A quick 10-mile drive to the Santa Fe Plaza and all of its historic sights.



## DARLENE STREIT

SANTA FE REAL ESTATE PROPERTY

505.920.8001 • dstreit@dstreit.com

417 E. Palace Avenue • Santa Fe NM 87501



LISTINGS

Scan these QR Codes to view Darlene's listings online or to download our mobile app.

OR text DSTREIT to 87778, or go to: [m.sir.com/dstreit](http://m.sir.com/dstreit)



APP

To view additional photos of this property visit: [SantaFeRealEstateProperty.com](http://SantaFeRealEstateProperty.com)

Sotheby's International Realty and the Sotheby's International Realty logo are registered (or unregistered) service marks used with permission. Operated by Sotheby's International Realty, Inc. Real estate agents affiliated with Sotheby's International Realty, Inc. are independent contractor sales associates and are not employees of Sotheby's International Realty, Inc.

This material is based on information which we consider reliable, but because it has been supplied by third parties, we cannot represent that it is accurate or complete, and it should not be relied upon as such. This offering is subject to errors, omissions, change of price, or withdrawal without notice. EQUAL HOUSING OPPORTUNITY.

## Sotheby's

INTERNATIONAL REALTY

326 Grant Ave, Santa Fe, NM 87501

505-988-2533





## Stunning Contemporary Home w/ Adjacent Lot in Las Campanas

- 3 Bedrooms
- Baths: 2 Full, 1 Three Quarter, 1 Half
- Main House 4590 Sq. Ft.
- 4.45 Acres
- Built in 2009
- Frame, Stucco Construction \*
- Flat Roof
- 2 Garage Spaces
- 5 Fireplaces
- Concrete, Tile, Wood Floors
- Gas Cooking
- Radiant In Floor Heating
- Evaporative, Ductless Cooling
- Community Sewer
- Community Water
- Internet: Cable, DSL, Satellite
- HOA Fees: 2019: \$1435/qtr for both lots combined
- -or- \$717.50/qtr per lot
- HOA Fees Cover: Community Area & Road Maintenance, Security
- Insulated Windows
- Landscaped
- Drip/Sprinkler System
- Security System

*\*Buyer to Verify*

