

58 1/2 Paseo Nopal

4 Bedroom / 4 Bath / 2550 SF • \$499,000 • MLS# 201902939

DARLENE STREIT

SANTA FE REAL ESTATE PROPERTY

505.920.8001 • dstreit@dstreit.com

417 E. Palace Avenue • Santa Fe NM 87501

58 1/2 Paseo Nopal

4 Bedroom / 4 Bath / 2550 SF

\$499,000 • MLS# 201902939

58 1/2 PASEO NOPAL - FLOOR PLAN

This depiction is for illustration purposes and may not be entirely accurate



FLOOR PLAN - LEVEL TWO



58 1/2 PASEO NOPAL GUEST HOUSE FLOOR PLAN

This depiction is for illustration purposes and may not be entirely accurate

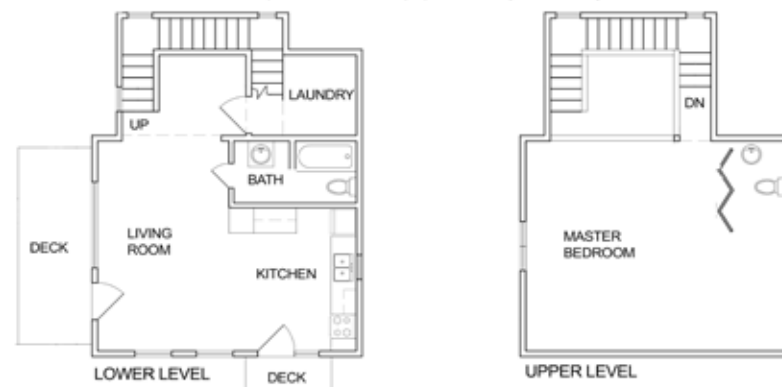

This sunny and bright 3 bedroom 1.5 bath Northern New Mexico style home plus guest house offers a 1550 sq ft main house recently-constructed in 2015 with an open concept floor plan and clean lines. Enter into the large combination living/dining area and kitchen with high, pitched ceilings, a wood stove, wood laminate floors, and find yourself surrounded by windows that let in the natural light. The kitchen has sleek stainless-steel appliances, butcher block countertops, stylish mixed-tile backsplash, and a breakfast bar. The master bedroom with walk-in closet, full bath and guest bedroom are located on the first level. An additional bedroom and bath upstairs could serve as an office, media room or studio. This home has numerous flexible outdoor living/dining

spaces including a spacious covered portal and a large side yard with views for miles. The detached 1,000 sq ft, guest house features a shady front porch with railing and has a loft with one bedroom and a half bath, plus a full bathroom in the downstairs living/kitchen area and is a perfect space for visitors or rental opportunities. Extra features include pitched metal roof, insulated windows, water purification system, landscaping, RV parking, and 2 carports: one for the main house, the other for the guest house. Energy star appliances and other green features including a Home Energy Rating Certificate. Convenient location just minutes to Santa Fe Plaza, Midtown theaters and restaurants, hospitals and shopping.



DARLENE STREIT

SANTA FE REAL ESTATE PROPERTY

505.920.8001 • dstreit@dstreit.com

417 E. Palace Avenue • Santa Fe NM 87501



LISTINGS

Scan these QR Codes to view Darlene's listings online or to download our mobile app.

OR text DSTREIT to 87778, or go to: m.sir.com/dstreit



APP

To view additional photos of this property visit: SantaFeRealEstateProperty.com

Sotheby's International Realty and the Sotheby's International Realty logo are registered (or unregistered) service marks used with permission. Operated by Sotheby's International Realty, Inc. Real estate agents affiliated with Sotheby's International Realty, Inc. are independent contractor sales associates and are not employees of Sotheby's International Realty, Inc.

This material is based on information which we consider reliable, but because it has been supplied by third parties, we cannot represent that it is accurate or complete, and it should not be relied upon as such. This offering is subject to errors, omissions, change of price, or withdrawal without notice. EQUAL HOUSING OPPORTUNITY.

Sotheby's

INTERNATIONAL REALTY

326 Grant Ave, Santa Fe, NM 87501

505-988-2533





Northern NM Style Home & Guesthouse

- 4 Bedrooms
- Baths: 2 Full, 2 Half
- Main House 1550 Sq. Ft.
- Guest House 1000 Sq. Ft.
- 1.18 Acres
- Main House Built in 2015
- Guest House Built in 1996
- Frame Stucco Construction *
- Metal Propanel, Pitched Roof
- Carpet, Laminate, Tile, Wood Floors
- Gas, Propane Cooking
- Wood Stove, Ductless (MiniSplit) Heating
- Ductless Cooling
- Septic
- Shared Well
- Internet: DSL
- Insulated Windows
- Xeriscaped
- RV Parking Available
- Water Purification
- EnergyStar Appliances
- Passive Solar Design
- Rainwater Harvesting
- Tankless Hot Water
- Low Flow Fixtures

**Buyer to Verify*

