

# 906 Canyon Road

4 Bedroom / 5 Bath / 3700 SF • \$1,995,000 • MLS# 201805865

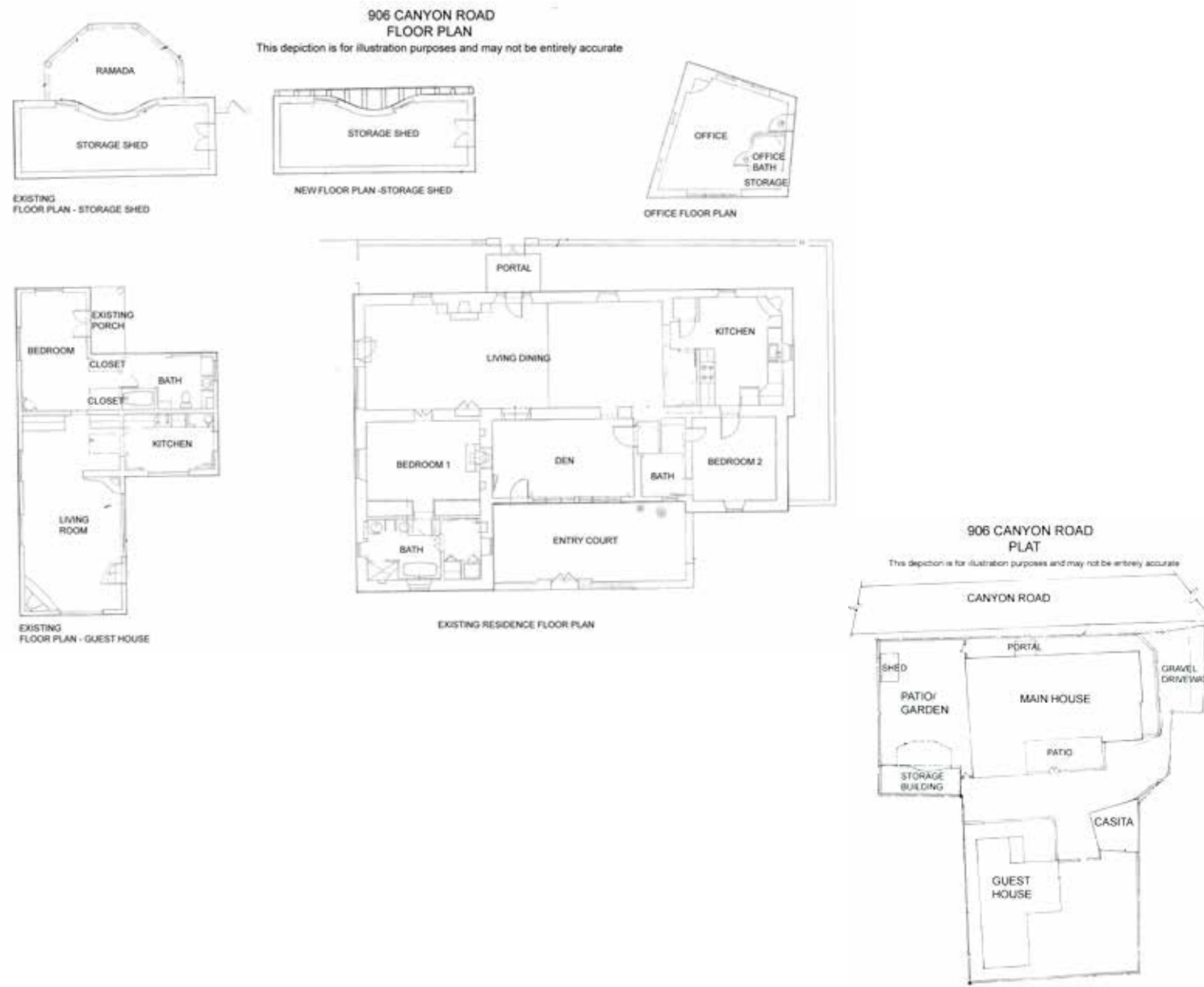

# DARLENE STREIT

SANTA FE REAL ESTATE PROPERTY

505.920.8001 • dstreit@dstreit.com

417 E. Palace Avenue • Santa Fe NM 87501

# 906 Canyon Road

4 Bedroom / 5 Bath / 3700 SF

\$1,995,000 • MLS# 201805865



A rare opportunity to own this adobe 4 bedroom 5 bath compound in the midst of the Canyon Road's magical mile in Santa Fe's historic arts district. Experience fine art, great shopping and world class dining any day of the week. Comprised of three separate structures, this compound affords space for multiple living options or gallery/studio space. Entering the main house, you will encounter a generous living/dining area with brick floors, high beamed ceilings and a sizable kiva. "The well-appointed kitchen has new (2018) appliances including a Wolf range, a Bosch dishwasher and a Sub-zero refrigerator. There are two bedrooms and three baths in the main house. Stay snug in the winter in the master suite with kiva and a wall of built in closets and drawers.

The guesthouse offers privacy and comfort for visitors with a bedroom, bath, kitchen and living/studio area, washer/dryer plus its own walled garden and old growth trees. The original well house has been cleverly adapted into a charming casita and the historic hand dug well has been uniquely preserved and is a delightful visual accent to the casita. Extensive repairs and remodeling were done by the current owners in 2018 including new Brai roof on both main/guest house and outbuilding, skylights, updated baths, solar panels on main/guest house and new stucco all done per historic preservation guidelines. Off street parking and storage out buildings complete this exclusive property. Zoned for residential/commercial use.



## DARLENE STREIT

SANTA FE REAL ESTATE PROPERTY

505.920.8001 • dstreit@dstreit.com

417 E. Palace Avenue • Santa Fe NM 87501



LISTINGS

Scan these QR Codes to view Darlene's listings online or to download our mobile app.

OR text DSTREIT to 87778, or go to: [m.sir.com/dstreit](http://m.sir.com/dstreit)



APP

To view additional photos of this property visit: [SantaFeRealEstateProperty.com](http://SantaFeRealEstateProperty.com)

Sotheby's International Realty and the Sotheby's International Realty logo are registered (or unregistered) service marks used with permission. Operated by Sotheby's International Realty, Inc. Real estate agents affiliated with Sotheby's International Realty, Inc. are independent contractor sales associates and are not employees of Sotheby's International Realty, Inc.

This material is based on information which we consider reliable, but because it has been supplied by third parties, we cannot represent that it is accurate or complete, and it should not be relied upon as such. This offering is subject to errors, omissions, change of price, or withdrawal without notice. EQUAL HOUSING OPPORTUNITY.

## Sotheby's

INTERNATIONAL REALTY

326 Grant Ave, Santa Fe, NM 87501

505-988-2533





## Live and/or Work Compound on Canyon Road's Magical Mile

- 4 Bedrooms
- Baths: 2 Full, 1 Three Quarter, 1 Half
- Main House 2362 Sq. Ft.
- Guest House 1024 Sq. Ft.
- Studio 314 Sq. Ft.
- 0.25 Acres
- Built in 1955
- Adobe and possibly other materials, Block, Brick, Frame, Construction \*
- Flat Roof
- 7 Fireplaces
- Brick, Wood Floors
- Gas Cooking
- Active Solar, Baseboard, Electric, Heat Pump, Fireplace Insert Heating
- Heat Pump Cooling
- City Sewer
- City Water
- Internet: Cable, DSL, Satellite
- Landscaped
- Security System
- Out Buildings
- Drip/Sprinkler System

*\*Buyer to Verify*

